

St Peter's College Cross Country Course

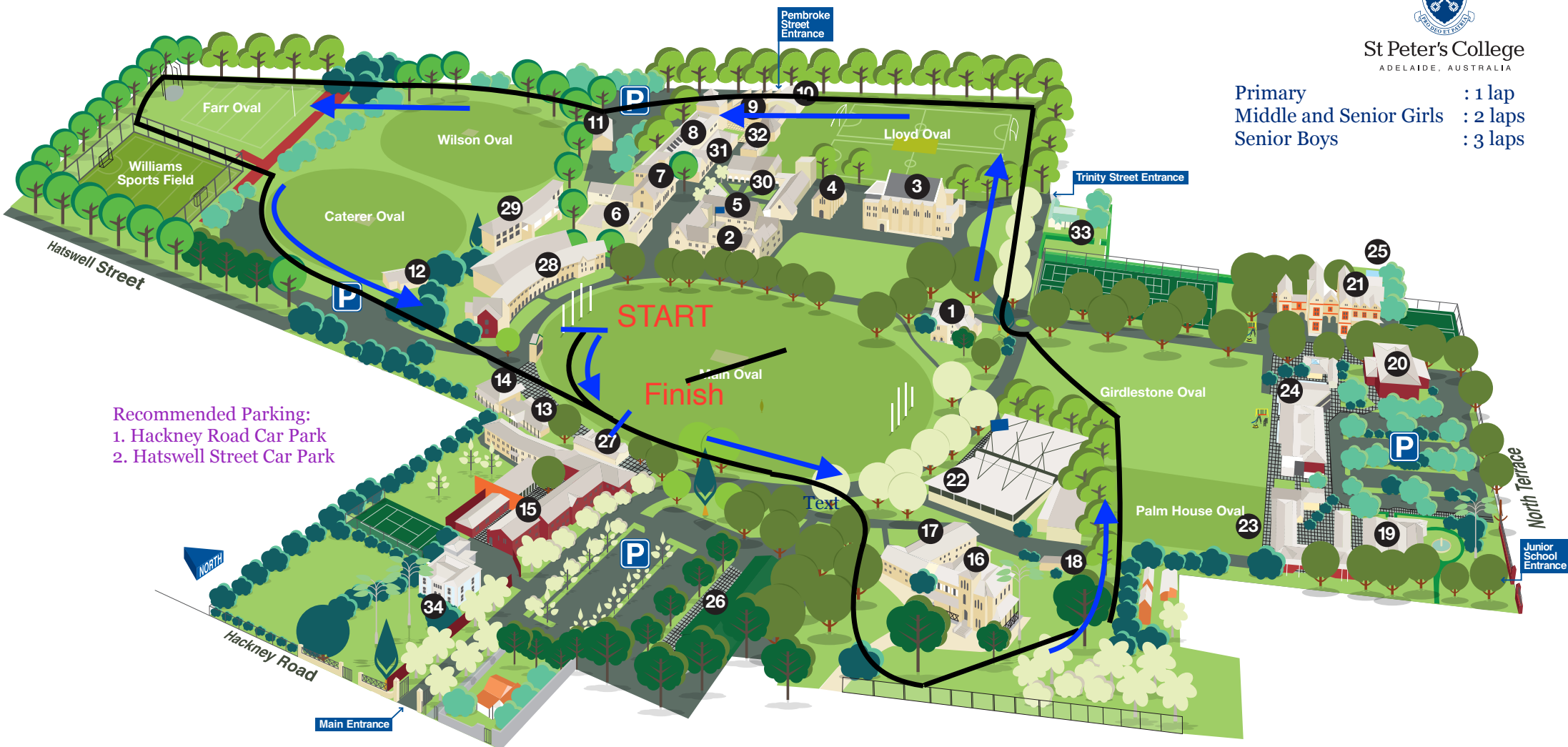

St Peter's College
ADELAIDE, AUSTRALIA

Primary : 1 lap
Middle and Senior Girls : 2 laps
Senior Boys : 3 laps



Recommended Parking:
1. Hackney Road Car Park
2. Hatswell Street Car Park

St Peter's College

St Peters, Adelaide, Australia, 5069

+618 8404 0400

stpeters.sa.edu.au

@SPC_Adelaide

- | | | | |
|--|---------------------------------------|--|---------------------------------------|
| 1. Oval House (visitors and enquiries) | 9. Art and Technology | 18. Uniform Shop | 27. Nitschke Pavilion |
| 2. Old School House / Headmaster's Office (Senior School administration) | 10. Drama | 19. Old Palm House (Early Learning Centre) | 28. Pentreath Building (Middle Years) |
| 3. Memorial Hall | 11. Maintenance and Grounds Workshops | 20. Junior School Hall | 29. Gordon Building |
| 4. Chapel | 12. Brookman Pavilion | 21. Shinkfield Building | 30. Big Quad |
| 5. Big School Room | 13. Health Centre | 22. Burchnall Sports Centre | 31. Information Technology |
| 6. Miller Library | 14. Tuck Shop | 23. New Palm House | 32. Senior School Changerooms |
| 7. Da Costa Dining Hall and Kitchen | 15. Boarding House | 24. Bickersteth (Junior School administration) | 33. College House |
| 8. Florey Science | 16. Athelney House | 25. Junior School Pool | 34. Allen House |
| | 17. Hill Wing Music Centre | 26. Goat Paddock Shed | |